

#### Description

Push-fit type accessory with diameters 16, 20, 25 and 32 mm, for use by professionals in plumbing installations, high and low temperature heating, air conditioning, compressed air and industrial installations.

Manufactured in PPSU body, fixed radial compression bushing in tempered AISI 304 stainless steel and attached to the body of the accessory by a PPSU ring. Accessory with internal sealing between it and the pipe.

#### Brand

SharkBite NEXUS



#### Materials

No.	Component	Material	Normative
1	cap	PPSU	
2	Cap holder	PPSU	
3	O-ring	EPDM Perox 70	UNI EN 681-1 Type WB
4	Body	PPSU	
	Male/female connection	Brass CW617N	UNI EN 12165



Composition	Cu	To the	Faith	Neither	Pb	Yes
Brass CW617N	57.0-59.0	Max. 0.05	* Max. 0.30*	* Max. 0.1	* 1.6-2.2	Max. 0.30

\* Low content of Lead and Nickel in accordance with the European Directive 98/83/EC and the German Standard DIN 50930.

#### Manufactured in accordance with international standards

##### ISO 21003

Multilayer piping systems for hot and cold water installations within buildings.

##### ISO 15875

Plastic piping systems for cold water installations - cross-linked polyethylene (PE-X).

#### Properties

Maximum temperature	140°C
Minimum temperature	- 40°C
Maximum pressure at 95°C	10 Bar
Maximum pressure at 20°C	100 Bar

#### SharkBite Pipe Compatibility

Sharkbite Multilayer  
SharkBite PEXa  
SharkBite PEXa UV BLACK  
SharkBite PERT

#### Compatible pipes section

Ø16x1.8 mm Ø25x2.3 mm  
Ø16x2.0 mm Ø25x2.5 mm  
Ø20x1.9 mm Ø32x2.9 mm  
Ø20x2.0 mm Ø32x3.0 mm  
Ø20x2.3 mm



001/6677



001/6678

ISO15875  
Application class  
Design pressure (bar)  
1/6;2/16;4/8;5/6



001/7526

ISO21003  
Application class  
Design pressure (bar)  
1/6;2/16;4/6;5/6

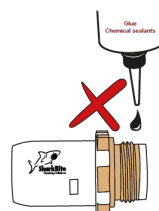

The sealants Anaerobic used for threads metallic cause stress cracking and rupture in contact with thermoplastic materials. Regardless of whether the threads of the accessories are metallic, indirect or accidental contact with the plastic parts of PPSU can cause breaks or cracks. Only thread, PTFE tape or hemp/tow should be applied to SharkBite NEXUS accessories.

#### Applications

