

- NEXUS RANGE -



Solutions to Shape the World™



Available in ø16, 20, 25, & 32 mm

# RWC



COMPATIBLE WITH PIPES

Ø 16 x 1.8  
Ø 16 x 2.0  
Ø 20 x 1.9  
Ø 20 x 2.0  
Ø 25 x 2.3  
Ø 25 x 2.5  
Ø 32 x 2.9  
Ø 32 x 3.0



PEXa - Multilayer



PROFESSIONAL



QUICK



RELIABLE



COST  
EFFICIENT



RELIANCE WORLDWIDE CORPORATION EUROPE

Autovía A92 - Km 209  
18370 Moraleda Zafayona  
Granada (Spain)

Tel. +34 958 49 70 00  
info.europe@rwc.com

The most reliable and quick  
**Professional** system for  
**Plumbing and Heating** on the  
market, compatible with **PEX**  
and **Multilayer** pipe.

[www.sharkbite.es](http://www.sharkbite.es)



[https://www.youtube.com/channel/UCSV5n\\_WOynJWIOI7SAEhWEA/videos](https://www.youtube.com/channel/UCSV5n_WOynJWIOI7SAEhWEA/videos)



NEXUS assembly instructions:  
[https://www.youtube.com/watch?v=yb\\_U6LIHcM&t=9s](https://www.youtube.com/watch?v=yb_U6LIHcM&t=9s)

NEXUS is a system of installation for plumbing and heating where no particular tools are needed.

50% stock reduction due to the compatibility with PEXa and MULTILAYER pipes.

Made of PPSU (poliphenilsulone).

Easy to install, reliable and flexible.

NEXUS is a system for professionals.

GREEN indicator denotes immediately that the connection has been performed correctly.

Cuerpo	PPSU ( Polifenilsulfona )
Clamp	PPSU ( Polifenilsulfona )
Sleeve	PPSU ( Polifenilsulfona )
Sealing element	EPDM Peróxido 70
Bevel Ring	POM ( Poliacetal )
Range	ø 16 - ø 20 - ø 25 - ø 32 mm
Compatible with pipes	SharkBite PEXa SharkBite Multilayer SharkBite PEXa UV Black Protection SharkBite PEXa EVOH ( 5 ca pas ) Sharkbite PERT EVOH ( 5 capas )

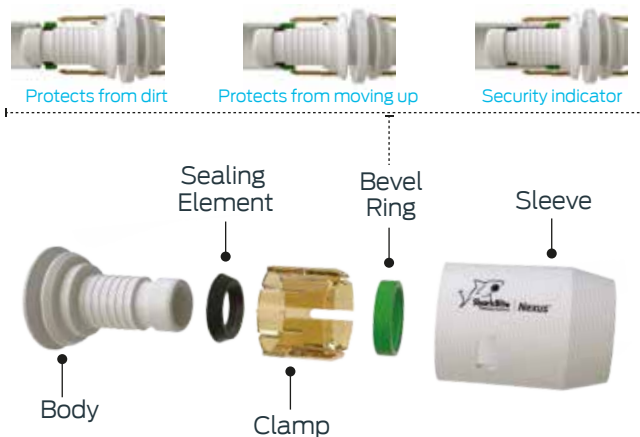

PATENTED

EP 2 39 741 A1  
WO 2010/092213  
U 200900267  
1 069 660

SharkBite NEXUS is a system patented by Reliance WorldWide Corporation Europe S.L.

10 years warranty ( 25.000.000 \$ )



## - ASSEMBLY INSTRUCTIONS -

### Installation with PEXa or MULTILAYER pipe

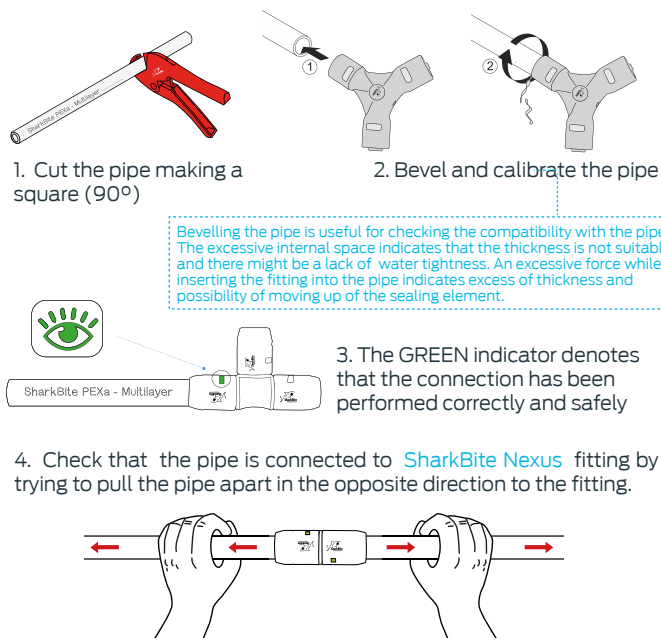

Caution: Be careful with using chemical threads sealants, solvents, PVC glues and chemical products in general.

Especially the anaerobic sealants used for metal threads cause stress cracks and breaks in contact with thermoplastic materials.

Regardless of whether the threads of the accessories are metallic, the indirect or accidental contact with the plastic parts of PPSU can cause breakage or cracking.

Only PTFE thread or tape, hemp / tow must be applied in SharkBite NEXUS accessories.



## MANIFOLDS INSTALLATION

Easy to install  
Pressure and flow, compensated

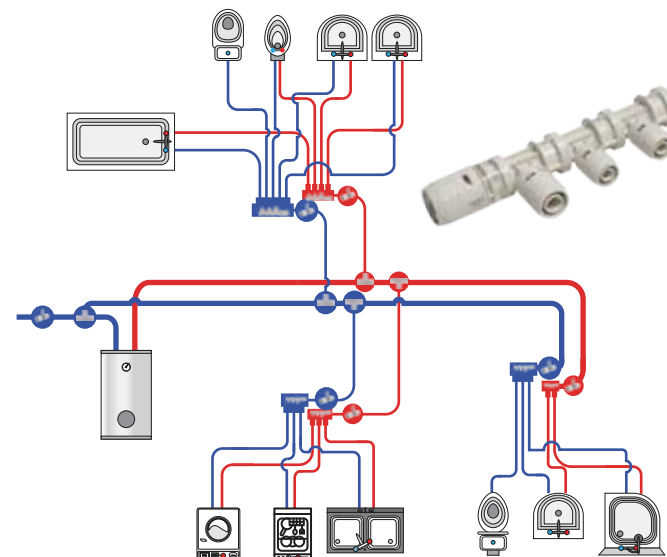

## DISTRIBUTORS INSTALLATION

Easy to install  
Pressure and flow compensated.  
Reduce the hot water waiting time without the need for recirculation line.

