

- PRESS RANGE -



Solutions to Shape the World™



Available in ø 16, 20, 25, 26 & 32 mm

**RWC**



COMPATIBLE WITH PIPES

Ø 16 x 1.5  
Ø 16 x 1.8  
Ø 16 x 2.0  
Ø 20 x 1.9  
Ø 20 x 2.0  
Ø 25 x 2.3  
Ø 25 x 2.5  
Ø 32 x 2.9  
Ø 32 x 3.0



PEXa - Multilayer



PROFESSIONAL



QUICK



RELIABLE



COST  
EFFICIENT



RELIANCE WORLDWIDE CORPORATION EUROPE

Autovía A92 - Km 209  
18370 Moraleda Zafayona  
Granada (Spain)

Tel. +34 958 49 70 00  
info.europe@rwc.com

The most reliable and quick  
Professional system for  
**Plumbing and Heating** on the  
market, compatible with **PEX**  
and **Multilayer** pipe.

[www.sharkbite.es](http://www.sharkbite.es)



[https://www.youtube.com/channel/UCSV5n\\_WOynJWIOI7SAEhWEA/videos](https://www.youtube.com/channel/UCSV5n_WOynJWIOI7SAEhWEA/videos)



PRESS assembly instructions:  
<https://youtu.be/f8ibWOYNFqU>



**PRESS** Is a system of installation for Plumbing and Heating.

50% stock reduction due to the compatibility with **PEXa** and **MULTILAYER** pipes.

Compatible with all the most used profiles on the market and all the pressing tools  
- RF - U - TH -

Made in **PPSU** (polyphenylsulfone).

**PRESS** is a system for professionals

Body	PPSU ( Polifenilsulfona )
Stainless Steel Sleeve	AISI 304 Templado
Stainless Steel Block element	PPSU ( Polifenilsulfona )
Sealing element	EPDM Peróxido 70
Range	Ø 16 - Ø 20 - Ø 25 - Ø 26 y Ø 32 mm
Compatible with pipes	SharkBite PEXa - SharkBite PERT SharkBite Multilayer SharkBite PEXa UV Black Protection SharkBite PEXa EVOH ( 3 y 5 ca pas ) Sharkbite PERT EVOH ( 3 y 5 capas )

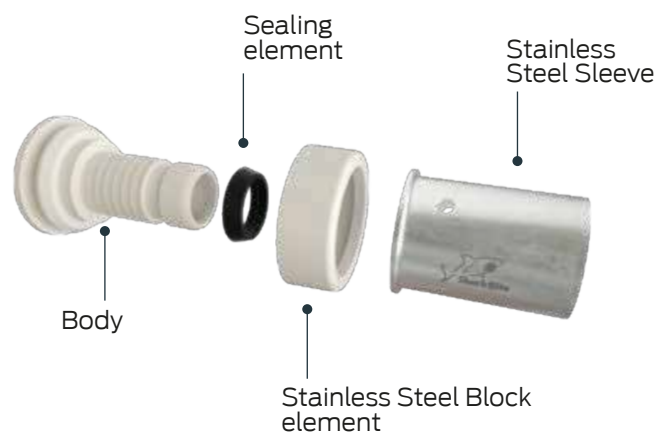

## - ASSEMBLY INSTRUCTIONS -

### Installation with PEXa or MULTILAYER pipe

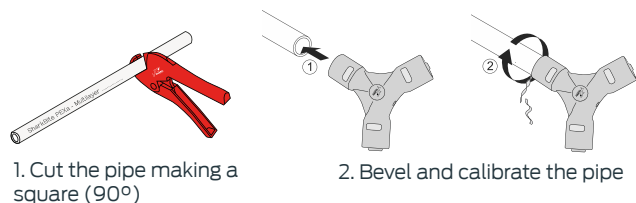

3 - Insert the bevelled pipe end into the fitting **SharkBite PRESS**, until it stops and visually check through the inspection window to ensure that the pipe is fully home.

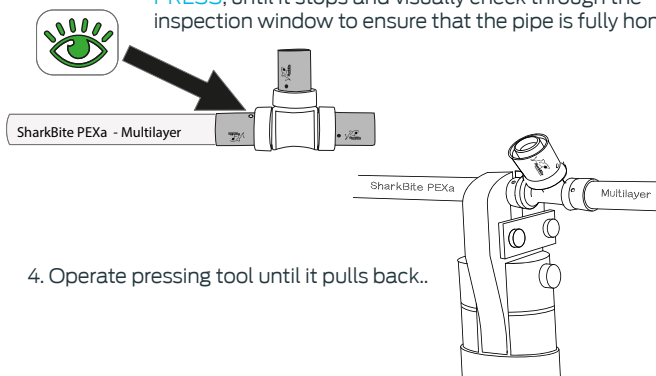

**Caution:** Be careful with using chemical threads sealants, solvents, PVC glues and chemical products in general.

Especially the anaerobic sealants used for metal threads cause stress cracks and breaks in contact with thermoplastic materials.

Regardless of whether the threads of the accessories are metallic, the indirect or accidental contact with the plastic parts of PPSU can cause breakage or cracking.

Only PTFE thread or tape, hemp / tow must be applied in **SharkBite PRESS** accessories



Check that the clamp is positioned correctly, aligned with the fixed stainless steel sleeve.

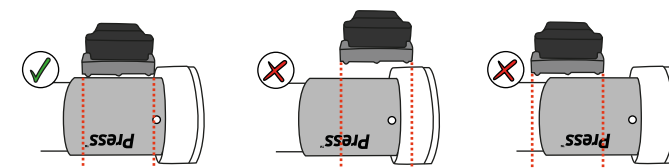

Pressing / profile types compatible with **SharkBite PRESS** accessories in **PEXa** or **Multilayer** pipes:

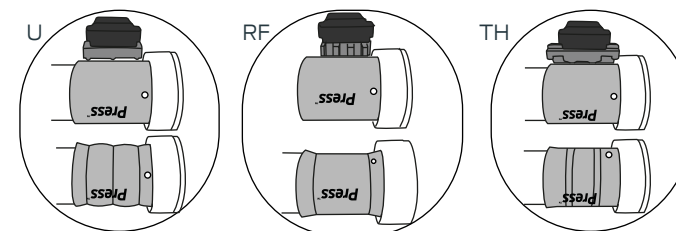

Consult for other types of pressing / profile

### - PEXa pipe

	Ø 16	Ø 20	Ø 25	Ø 26	Ø 32
U	✓	✓	✓	✗	✓
RF	✓	✓	✓	✗	✓
TH	✓	✓	✓	✗	✓

### - Multilayer pipe

	Ø 16	Ø 20	Ø 25	Ø 26	Ø 32
U	✓	✓	✓	✓	✓
RF	✓	✓	✓	✓	✓
TH	✓	✓	✓	✓	✓

Do not use any tools or lubricant for the introduction of the pipe into the fitting **SharkBite PRESS**. Straightly insert the pipe into the fitting.

